



# STORAGE, HANDLING, AND SAFETY RECOMMENDATIONS FOR APA PERFORMANCE RATED I-JOISTS

To assure optimum performance and safe handling, APA trademarked I-joists must be stored and applied properly. The following guidelines will help protect joists from damage in storage, during shipment, and on the construction site, and protect the installer from jobsite injury.

## Storage and Handling

1. Store, stack and handle I-joists vertically and level only.

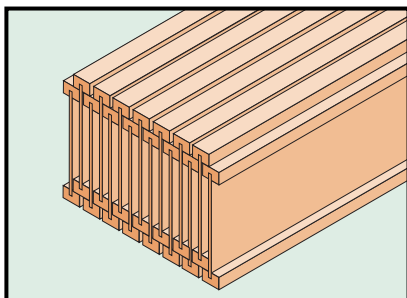

2. Do not store I-joists in direct contact with the ground and/or flatwise.

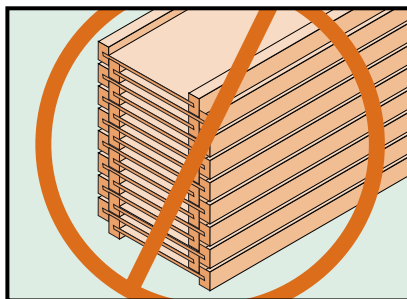

3. Protect I-joists from weather, and use stickers to separate bundles.

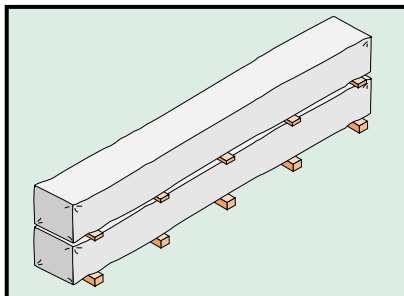

4. To further protect I-joists from dirt and weather, do not open bundles until time of installation.

5. Take care not to damage I-joists with forklifts or cranes.

6. Do not twist or apply loads to the I-joist when horizontal.

7. Never use or try to repair a damaged I-joist.

8. When handling I-joists with a crane on the job site ("picking"), take a few simple precautions to prevent damage to the I-joists and injury to your work crew.

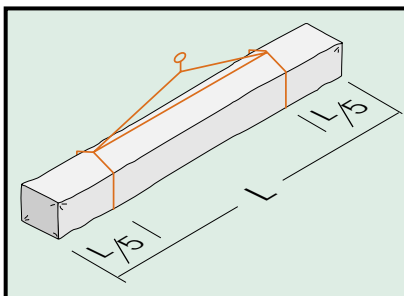

- Pick I-joists in bundles as shipped by the supplier.
- Orient the bundles so that the webs of the I-joists are vertical.
- Pick the bundles at the 5th points, using a spreader bar if necessary.

## Safety Tips

I-joists are not stable until completely installed, and will not carry any load until fully braced and sheathed.

Do not allow workers to walk on I-joists until joists are fully installed and braced, or serious injuries can result.

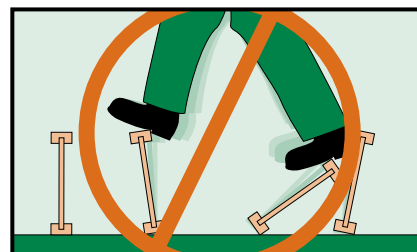

Never stack building materials over unsheathed I-joists. Stack only over beams or walls.

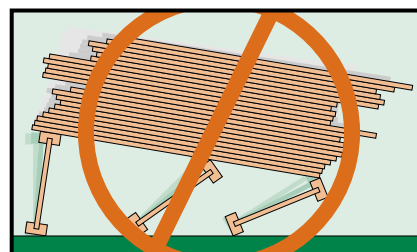

## Avoid accidents by following these important guidelines:

1. Brace and nail each I-joint as it is installed, using hangers, blocking panels, rim board, and/or cross-bridging at joint ends. When I-joists are applied continuous over interior supports and a load-bearing wall is planned at that location, blocking will be required at the interior support.

2. When the building is completed, the floor sheathing will provide lateral support for the top flanges of the I-joists. Until this sheathing is applied, temporary bracing, often called struts, or temporary sheathing must be applied to prevent I-joint rollover or buckling.

■ Temporary bracing or struts must be 1x4 inch minimum, at least 8 feet long and spaced no more than 8 feet on center, and must be secured with a minimum of two 8d nails fastened to the top surface of each I-joint. Nail bracing to a lateral restraint at the end of each bay. Lap ends of adjoining bracing over at least two I-joists.

■ Or, sheathing (temporary or permanent) can be nailed to the top flange of the first 4 feet of I-joists at the end of the bay.

3. For cantilevered I-joists, brace top and bottom flanges, and brace ends with closure panels, rim board, or cross-bridging.

4. Install and nail permanent sheathing to each I-joint before placing loads on the floor system. Then, stack building materials over beams or walls only.

5. Never install a damaged I-joint.

Failure to follow applicable building codes and span ratings, failure to use allowable hole sizes and locations, or failure to use web stiffeners when required can result in serious accidents. Follow these installation guidelines carefully.

We have field representatives in most major U.S. cities and in Canada who can help answer questions involving APA trademarked products. For additional assistance in specifying APA engineered wood products, get in touch with your nearest APA regional office. Call or write:

### WESTERN REGION

7011 So. 19th St. ■ P.O. Box 11700  
Tacoma, Washington 98411-0700  
(253) 565-6600 ■ Fax: (253) 565-7265

### EASTERN REGION

2130 Barrett Park Drive, Suite 102  
Kennesaw, Georgia 30144-3681  
(770) 427-9371 ■ Fax: (770) 423-1703

### U.S. HEADQUARTERS AND INTERNATIONAL MARKETING DIVISION

7011 So. 19th St. ■ P.O. Box 11700  
Tacoma, Washington 98411-0700  
(253) 565-6600 ■ Fax: (253) 565-7265



[www.apawood.org](http://www.apawood.org)

### PRODUCT SUPPORT HELP DESK

(253) 620-7400  
E-mail Address: [help@apawood.org](mailto:help@apawood.org)

(Offices: Antwerp, Belgium; Bournemouth, United Kingdom; Hamburg, Germany; Mexico City, Mexico; Tokyo, Japan.) For Caribbean/Latin America, contact headquarters in Tacoma.

*The product use recommendations in this publication are based on APA – The Engineered Wood Association's continuing programs of laboratory testing, product research, and comprehensive field experience. However, because the Association has no control over quality of workmanship or the conditions under which engineered wood products are used, it cannot accept responsibility for product performance or designs as actually constructed. Because engineered wood product performance requirements vary geographically, consult your local architect, engineer or design professional to assure compliance with code, construction, and performance requirements.*

Form No. Z735  
Issued January 2000/0010

**A P A**

The Engineered Wood Association

